

1RUBMSTD

DESCRIZIONE Rubinetto Miscelatore STEEL DOCCIA
DESCRIPTION SHOWER STEEL mixer tap

PESO LORDO 2.7 kg
GROSS WEIGHT

DIMENSIONI IMBALLO 590x250x95 mm
PACKAGING DIMENSIONS

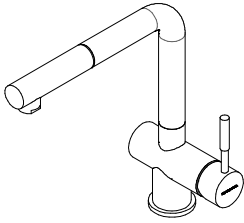

- 1RUBMSTD ACCIAIO INOX SATINATO AISI 304
 1RUBMSTDV ACCIAIO INOX VINTAGE AISI 304
- Acciaio inox AISI 304 (Stainless Steel AISI 304)
 - Cartuccia: dischi ceramici (Ceramic disc cartridge)
 - Rotazione canna: 180° (Top rotation: 180°)
 - Base rubinetto: Ø 50 mm (Tap Base)
 - Foro Rubinetto: Ø 35 mm (Tap Hole)
 - Portata media: 7.3 litri / min (Average Flow: 7.3 l/min)

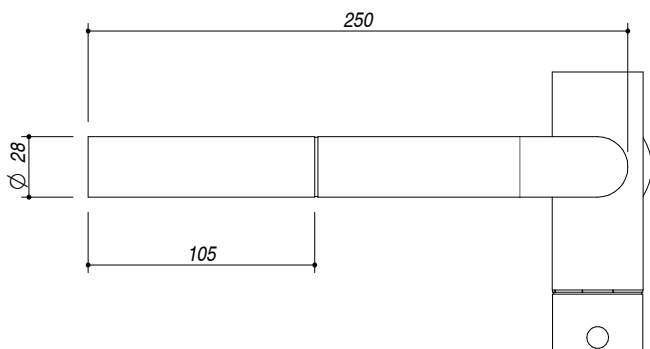
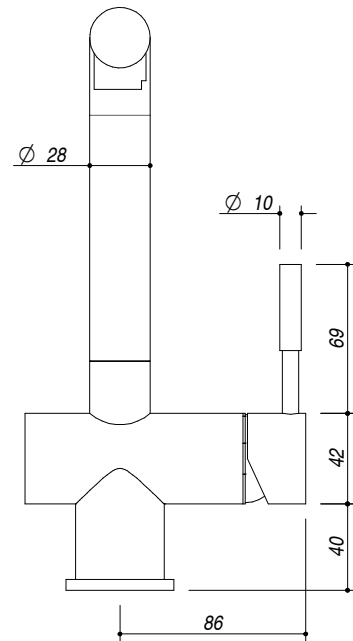
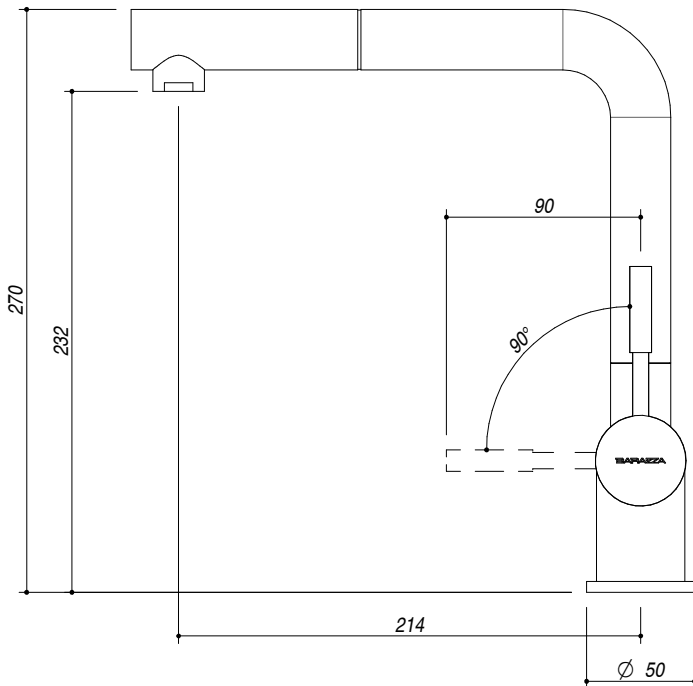

SCALA DISEGNO 1:3.5
DRAWING SCALE



TUTTE LE MISURE IN mm
ALL MEASURES IN mm

TOLLERANZA LINEARE: ± 0.5 mm
LINEAR TOLLERANCE

TOLLERANZA ANGOLARE: ± 0.2 °
ANGULAR TOLLERANCE

PER QUALSIASI CONTESTAZIONE SI FARA' RIFERIMENTO ESCLUSIVAMENTE A QUESTO DISEGNO
 For any dispute the company will refer exclusively to this drawing

BARAZZA Barazza s.r.l. - Via Risorgimento, 14 - 31025 Sarano dS Lucia di P. (TV) Italy
 Tel. +39/0438/62888 - Fax +39/0438/64901 info@barazzasrl.it - www.barazzasrl.it
 Documento di proprietà aziendale. La Società tutelerà i propri diritti a termini di legge.

